



GATES CHILI CENTRAL SCHOOL DISTRICT

*Together we teach and inspire excellence for all learners.*

*New to District Orientation:*

*6<sup>th</sup> - 8<sup>th</sup> Grade*

August 21, 2019

# Presenters

- **Dr. Buckshaw, Principal**
- **Mrs. Emily Rice, School Counselor**
- **Middle School Peer Ambassadors**
  - Maddie Basset
  - Ella Coleman
  - Leah Montulli
  - Adriana Ferrara
  - Alexa Ferrara
  - Alyssa Kilner
  - Rachel Reifsteck



**GATES CHILI CENTRAL SCHOOL DISTRICT**

*Together we teach and inspire excellence for all learners.*

# Purpose

- To communicate information about the Middle School program and provide an opportunity for students and families to orient themselves to a new school and district.



**GATES CHILI CENTRAL SCHOOL DISTRICT**

*Together we teach and inspire excellence for all learners.*

# Agenda

- About our Middle School and Capital Project
- Laptops
- Code of Conduct and Character
- Typical Day and Program Summary
- Counselor Role and Communication
- Clubs and Activities
- Activity Period, Lockers, and School Nutrition
- Health Office
- Start-up Information



**GATES CHILI CENTRAL SCHOOL DISTRICT**

*Together we teach and inspire excellence for all learners.*

# About Our School

GCMS consists of Small Learning Communities...

- three learning communities spanning grades 6-8
- typically, students remain in the same community throughout their middle school experience
- communities are housed in separate wings of the building
- each community has its own administrator and teams of teachers
  - Amerk Assistant Principal- Mrs. Scott
  - Redwing Assistant Principal- Mrs. Doty
  - Rhino Assistant Principal- Mr. Tavelaris



**GATES CHILI CENTRAL SCHOOL DISTRICT**

*Together we teach and inspire excellence for all learners.*

# *Capital Project*

1. Science

1. Family and Consumer Science

2. Counseling Suite

3. Bookstore

4. Security Station

5. Health Office

6. Special education rooms for programming

7. Art

8. PE Large gym floor, new bleachers, renovated locker rooms, fitness room, opportunity for future rock climbing wall

9. New student and staff bathrooms

**GATES CHILI CENTRAL SCHOOL DISTRICT**

*Together we teach and inspire excellence for all learners.*





**Core Academic**  
**Gates-Chili CSD Phase 1.3 - Middle School**

**GATES CHILI CENTRAL SCHOOL DISTRICT**  
*Together we teach and inspire excellence for all learners.*



PERSPECTIVE FRC  
DESIC  
2017 CAPITAL IMPROV



PERSPECTIVE OF LIBRARY ENTRANCE

DESIGN DEVELOPMENT  
2017 CAPITAL IMPROVEMENT PROJECT  
03/15/18

**GATES CHILI CENTRAL SCHOOL DISTRICT**  
*Together we teach and inspire excellence for all learners.*



# Art



ART FROM TEACHING WALL



ART FROM COURTYARD



ART FROM DOOR



6' - 1'-0"

ART FINISHES  
2017 CAPITAL IMPROVEMENT PROJECT  
06/13/18

GATES CHILI CENTRAL SCHOOL DISTRICT  
*Together we teach and inspire excellence for all learners.*

# Counseling





# FACS

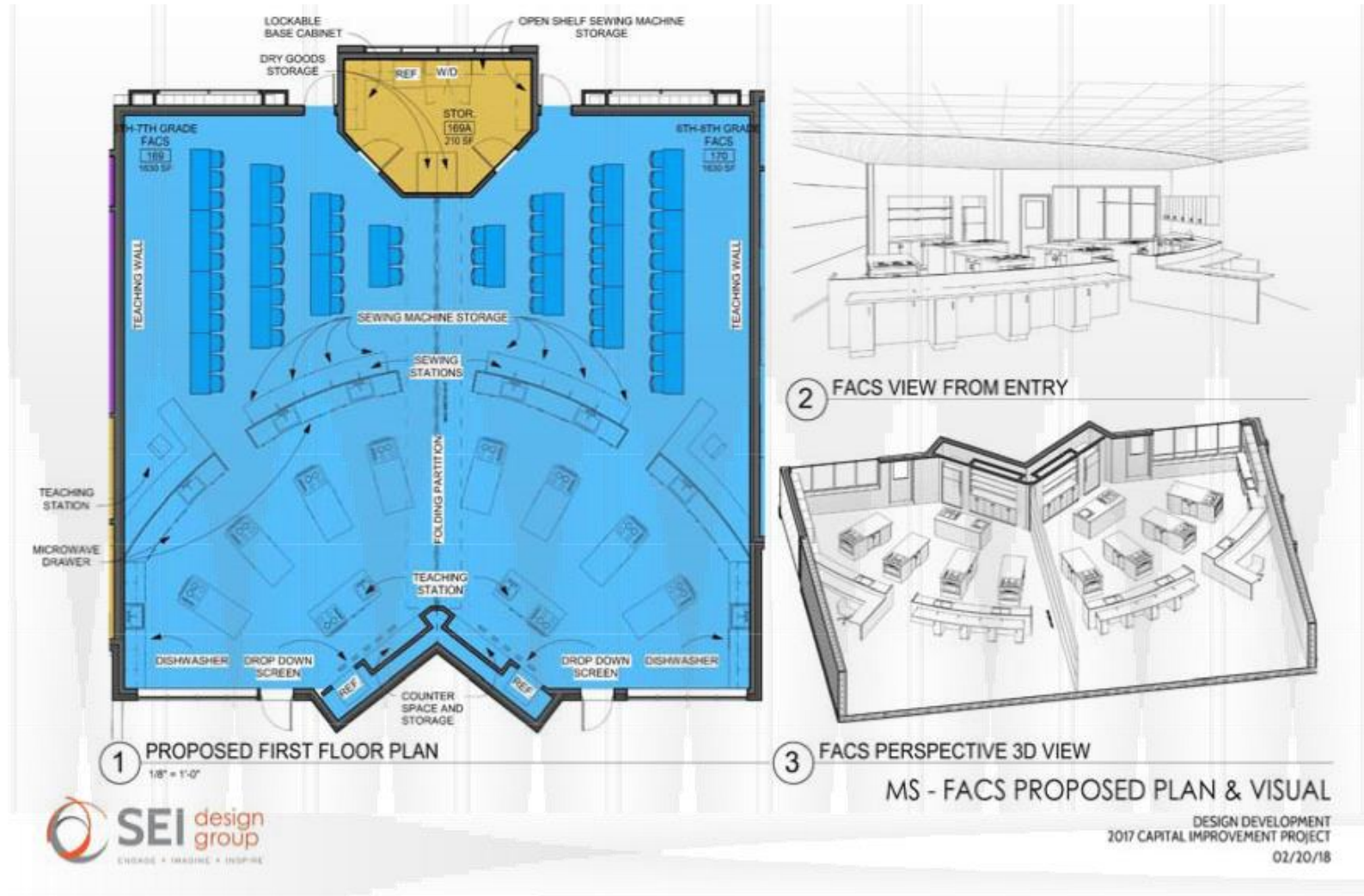

# Science

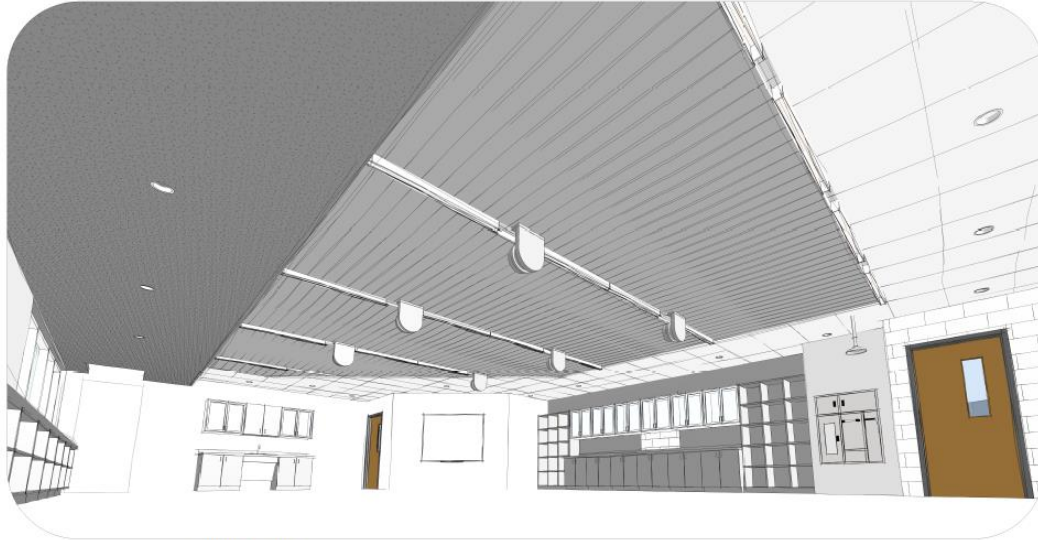

SCIENCE CEILING



SCIENCE STORAGE



SCIENCE ENTRANCE

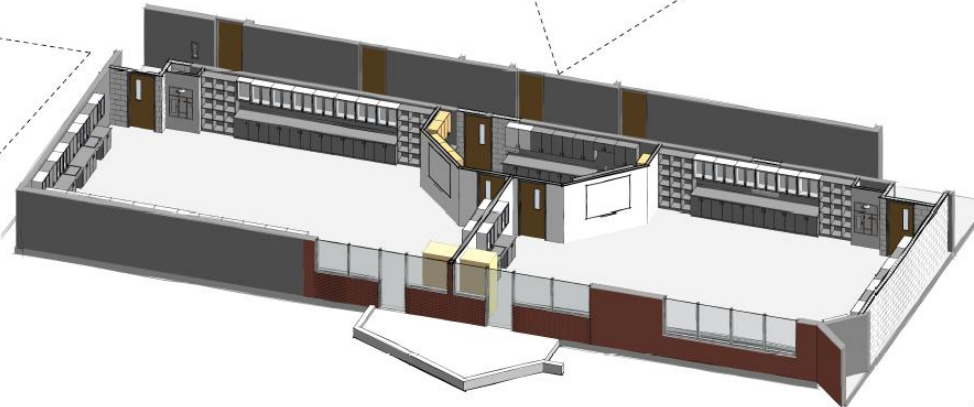

6" = 1'-0"

SCIENCE FINISHES  
2017 CAPITAL IMPROVEMENT PROJECT





# Student Laptops

- MS students receive individual laptops.
- Students, along with their parent(s)/guardian(s) who have signed the **Student Pledge**, and whose parent(s)/guardian(s) have signed the **User Agreement**, will be able to receive their devices. Students purchasing the Protection Plan (\$30) will be able to take the laptops home.
- **Distribution Days will be in the High School Field House as follows:**
- The Middle School will be open for families and students to pick-up laptops, set up lockers, and walk a child's schedule at the end of August as follows:
  - Monday, August 26, 2019: 3:00 – 7:00 pm
  - Wednesday, August 28, 2019: 3:00 – 7:00 pm

# *Other Electronics*

- Personal electronics can be carried to school, but must be placed in your child's locker during the school day.
- District issued laptop should be carried to every class (PE as requested).

# Code of Conduct

You, and you alone, are responsible for your behavior. Think of ways to exhibit exemplary behavior... (Reference the District Code of Conduct on our website [www.gateschili.org](http://www.gateschili.org))

- in your classroom
- in the hallway
- in the cafeteria
- in the bathroom
- on the school bus
- during field trips/assemblies

# GATES CHILI MIDDLE SCHOOL

		Classroom	Hallway	Cafeteria	Bathroom	School Bus	Field Trip/ Assembly/Sports
		Respect	<ul style="list-style-type: none"> <li>Work cooperatively with teachers and peers</li> <li>Follow classroom expectations</li> <li>Appropriately use materials</li> <li>Respect other's right to learn and participate without ridicule</li> </ul>	<ul style="list-style-type: none"> <li>Walk quietly and safely</li> <li>Be aware of your surroundings</li> <li>Take an active role in keeping your hall clean</li> <li>Respect others' personal space</li> <li>Walk to the right</li> </ul>	<ul style="list-style-type: none"> <li>Speak politely</li> <li>Use good manners</li> <li>Volume control</li> <li>Take pride in your cafeteria</li> <li>Be respectful in lunch line</li> <li>Keep hands to yourself and on your own belongings</li> </ul>	<ul style="list-style-type: none"> <li>Honor people's privacy</li> <li>Keep the environment clean for self and others</li> </ul>	<ul style="list-style-type: none"> <li>Follow adult instructions (bus driver, monitor, staff)</li> <li>Keep the aisle clear and stay in your seat</li> <li>Talk kindly and quietly</li> </ul>
Responsibility	<ul style="list-style-type: none"> <li>Come prepared to learn</li> <li>Ask for help</li> <li>Take ownership of your actions</li> <li>Complete classwork and homework</li> <li>Arrive on time</li> </ul>	<ul style="list-style-type: none"> <li>Get to class on time</li> <li>Keep locker organized</li> <li>Create a safe environment</li> <li>Report concerns</li> <li>Move quickly but safely</li> <li>Be a model for your peers</li> </ul>	<ul style="list-style-type: none"> <li>Stay in your seat</li> <li>Actively keep your area clean</li> <li>Follow cafeteria expectations</li> <li>Report concerns</li> </ul>	<ul style="list-style-type: none"> <li>Use bathroom appropriately</li> <li>Sign in and out</li> <li>Report concerns and vandalism</li> </ul>	<ul style="list-style-type: none"> <li>Keep track of your belongings</li> <li>Take ownership of your actions</li> <li>Get on your bus promptly and safely</li> <li>Report concerns</li> <li>Take all belongings with you, carry on carry off</li> </ul>	<ul style="list-style-type: none"> <li>Be an active participant</li> <li>Meet the expectations of the experience</li> <li>Positively represent your school and district</li> <li>Follow the social expectations of the setting</li> </ul>	
Compassion	<ul style="list-style-type: none"> <li>Be an upstander</li> <li>Be tolerant and open minded of others' idea and points of view</li> <li>Show kindness and understanding to all</li> </ul>	<ul style="list-style-type: none"> <li>Be an upstander</li> <li>Be helpful to others</li> <li>Treat others the way you want to be treated</li> <li>Speak kindly to others</li> <li>Speak using an inside voice</li> </ul>	<ul style="list-style-type: none"> <li>Be an upstander</li> <li>Be welcoming and helpful</li> <li>Find positive things to say (no gossip)</li> <li>Appreciate lunch staff (use manners)</li> <li>Welcome new students</li> <li>Invite others to sit with you</li> </ul>	<ul style="list-style-type: none"> <li>Be an upstander</li> <li>Be courteous of others</li> </ul>	<ul style="list-style-type: none"> <li>Be an upstander</li> <li>Allow others to sit with you</li> <li>Be welcoming and helpful</li> <li>Move all the way in so others feel welcomed</li> </ul>	<ul style="list-style-type: none"> <li>Be an upstander</li> <li>Listen with an open mind</li> <li>Learn from and support others</li> <li>Be appreciative</li> </ul>	
Hard Work	<ul style="list-style-type: none"> <li>Be a positive role model</li> <li>Don't give up, be persistent</li> <li>Stay on task</li> <li>Actively participate</li> <li>Try your best</li> </ul>	<ul style="list-style-type: none"> <li>Go directly to your destination</li> <li>Use time wisely</li> <li>Take time to plan out optimal routes with periodic locker stops throughout the day</li> </ul>	<ul style="list-style-type: none"> <li>Lead by example</li> <li>Make your lunch experience positive</li> <li>Use your time wisely, you only have 35 minutes</li> </ul>	<ul style="list-style-type: none"> <li>Go directly to and from the bathroom</li> <li>Use bathroom in a timely manner</li> </ul>	<ul style="list-style-type: none"> <li>Demonstrate appropriate actions and language</li> </ul>	<ul style="list-style-type: none"> <li>Monitor your own behavior</li> <li>Find value in and enjoy the experience</li> <li>Show effort and positive sportsmanship</li> <li>Be an active listener and follow directives</li> </ul>	



S  
P  
A  
R  
T  
A  
N  
W  
A  
Y





# Typical Day

## General Overview:

- 8 Day Rotation
- 6 Periods
- 59 Minute Classes
- 35 Minute Lunches
- Times around lunches will vary for the different communities
- 5-minute passing time

TIME		A	B	C	D	E	F	G	H
7:50-7:57	Arrival								
7:58 - 9:01	Class Time 1								
9:06 - 10:05	Class Time 2								
10:10 - 11:09	Class Time 3								
11:14 - 12:13	Class Time 4								
12:14 – 12:49	LUNCH								
12:54 - 1:53	Class Time 5								
1:58 - 2:57	Class Time 6								
3:02 – 3:30	Activities								

# Program Summary

## • 6<sup>th</sup> Grade

### 6 of 8 (40 weeks)

- Science
- Social Studies
- Math
- Reading
- ELA

### 3 of 8 (40 weeks)

- Band / Chorus
- AIS  
Literacy/Math

### 3 of 8 (20 weeks)

- Health
- Music
- Art
- FACS

## 7<sup>th</sup> Grade

### 6 of 8 (40 weeks)

- Science
- Social Studies
- Math
- English
- LOTE

### 3 of 8 (40 weeks)

- Band / Chorus
- AIS  
Literacy/Math

### 6 of 8 (20 weeks)

- Health
- FACS

## 8<sup>th</sup> Grade

### 6 of 8 (40 weeks)

- Science
- Social Studies
- Math
- English
- LOTE
- Technology

### 3 of 8 (40 weeks)

- Band / Chorus
- AIS
- Music
- Art

There are final exams in all courses that are weighted into your final average.

# *Counselor*

- works to facilitate student success in the middle school;
- helps with concerns related to academics, relationships, personal and family concerns;
- helps with student transitions;
- acts as a resource for parents and students;
- provides individual and group counseling
- new students become part of a student counseling group

# Communication

- conferences
- phone calls and *Connect-Ed*
- e-mails
- student agenda
- *Parent Portal*
- *Spartan Happenings*
- Website
- Twitter/Facebook/Instagram
- report cards
- 5 week Progress Reports (online only)

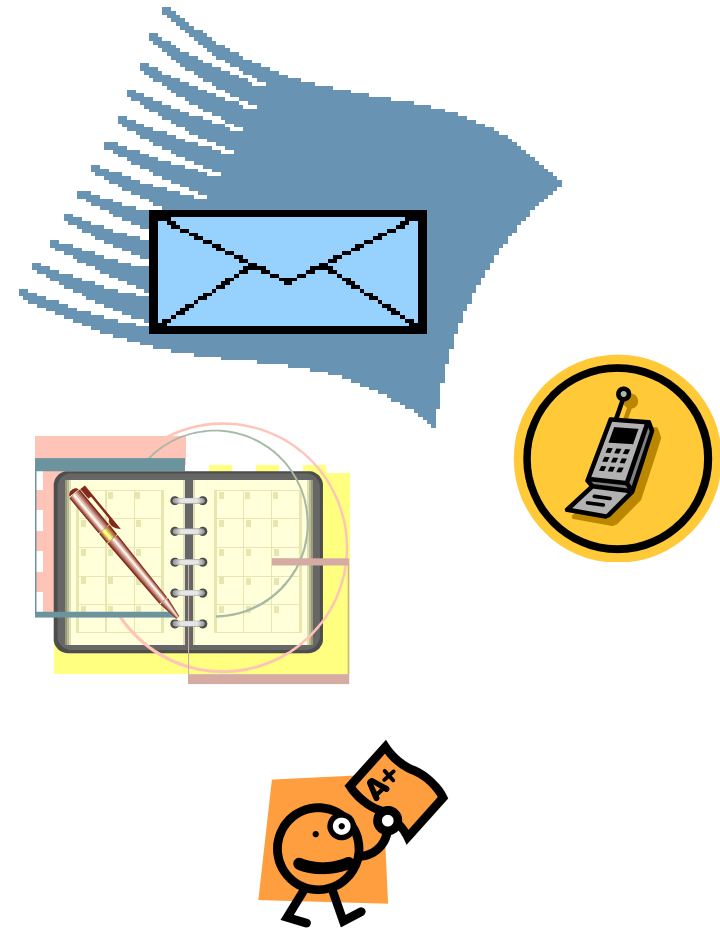



# Portal

The Parent/Student Portal allows you internet access to review:

- results of in-class tests
- assignments
- grades
- schedule
- discipline history

Five week reports are not mailed home. To access them, you will need to have access through Parent/Student Portal.

Primary guardian will receive automatic e-mail ???????. Everyone else can call Denise Falcipleri (247 – 5050 , ext. 12106) to obtain rights.

# Clubs and Activities

Clubs and activities are an important part of the Middle School experience. They usually meet once or twice monthly. MS clubs are organized by interest such as:

- STEM (Science, technology, engineering, and math)
- Literary Communication
- Social Science
- Fine Arts
- Service/Leadership
- Academic Competition
- Athletics



Join a club!

# Activity Period

- Activity period takes place after the regular school day from approximately 3:02-3:30.
  - clubs
  - Intramurals
  - extra help with teachers
  - make-up work
  - detention
- Late buses begin to arrive at 3:30 pm:  
Monday, Wednesday, Thursday, and Friday

# *Lockers*

- Every student at GCMS is assigned his/her own locker to store school supplies and belongings.
- Locker shelves can be helpful in keeping materials organized.
- Locker decorations need to be kept to the interior and cannot include writing on locker or taping the inside of the locker.

# School Nutrition Program

- <http://www.mypaymentsplus.com>
- HEALTHY choices for kids

*Families must apply for free/reduced lunch. It is not automatic. Failure to complete the application will result in charges against a child's account. The application is in the District calendar.*



 **Secure Sign In**

Username:

Password:

Remember username

 [Forgot your Username or Password? Click here...](#)

# Health Office

- medication distribution
- sports physicals
  - 7<sup>th</sup> and 8<sup>th</sup> grade only
- immunizations

Monroe County Health Department holds a free immunization clinic every Wednesday from noon until 7:00 p.m. Parents can call 585.753.5150 for more information.





# Start-up Information

- WHEN CAN I SET UP MY LOCKER?
  - Today
  - Monday, August 26, 2019: 3:00 pm – 7:00 pm.
  - Wednesday, August 28, 2019: 3:00 pm – 7:00 p.m.
  
- WHEN DO WE BEGIN?
  - Grades 6/7/8 – Wednesday , September 4, 2019
  
- WHERE DO WE GO?
  - A- Day, Period 1 Class
  
- WHAT SUPPLIES DO WE NEED?
  - List included in packet

# *Drop-off/Pick-up Location*

- Door #9 in the back of the building by the Cafeteria.
- There is no supervision before 7:35 am and after 3:45 pm. Students must be picked up immediately after school or after Activity Period (3:30 pm) if they are not taking the bus home.

# *Questions and Tours*